



Heritage Rotary 6-Line

Product Manual



Congratulations

Congratulations on the purchase of your new **Hills Heritage Rotary Clothesline**. It is important that you read this Product Manual thoroughly before installation and use. In this way you will benefit from all the design features and enjoy safe use of the product. Thank you for choosing Hills.

Warning

- Do not allow children or pets to swing on your Clothesline or items of laundry.
- Do not use your Clothesline for any purpose other than to hang and dry washing.
- Do not use your Clothesline if parts are worn or damaged.

Rotary Pack contents

ID	Part name	Qty.
1	Main Standard	1
2	Secondary Standard	1
3	Arm	4
4	Tube stay	4
5	Galvanised clothesline wire coil	1
6	Top cap	1
7	Arm stay bracket	4
8	Arm end cap	4
9	Screw RHMT M5 x 35mm	4
10	Screw RHMT M6 x 16mm	4
11	Screw RHMT M6 x 60mm	1
12	Nyloc nut M5	4
13	Nyloc nut M6	5
14	Hex Key	2
15	Stop Ring	1
16	Stop Ring Male Fastener	1
17	Stop Ring Female Fastener	1
18	Plug	1

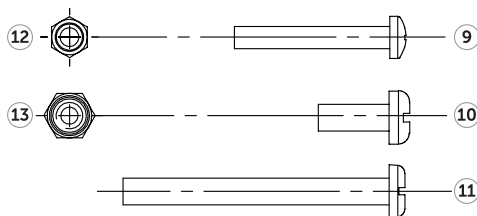

Please retain this Product Manual. Record the following information for future reference.

Product Number (printed on carton): _____

Date of purchase: _____

Name and location of store: _____



Designed and tested under a
Quality System that meets Hills
demanding quality specifications.

Made in China

Step 1 – Select a Suitable Location

- 1.1** Minimum recommended clearance on all sides of the Rotary is 1m (3'-3") (Fig. 1).

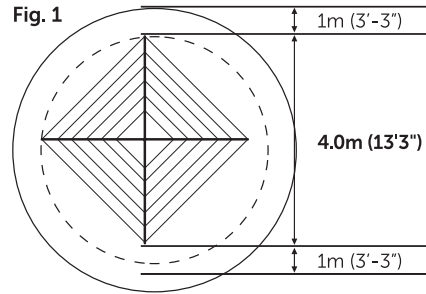

Step 2 – Install the Main Standard

- 2.1** Dig a 200mm (8") by 800mm (32") hole (Fig. 2).
- 2.2** Dig the hole deeper if you would like the clothesline to sit lower in the ground.
- 2.3** Fill with 150mm gravel
- 2.4** Insert main standard into the hole.
- 2.5** Concrete into position.
Concrete should be damp enough to hold together when squeezed in your hand.
Settle the concrete by pushing a thin stick into the mix several times.
Ensure the main standard is vertical.
- 2.6** Wait 48 hours for concrete to set.

Note: When installed using these depth dimensions the arm of the clothesline is 1.8m above the ground.

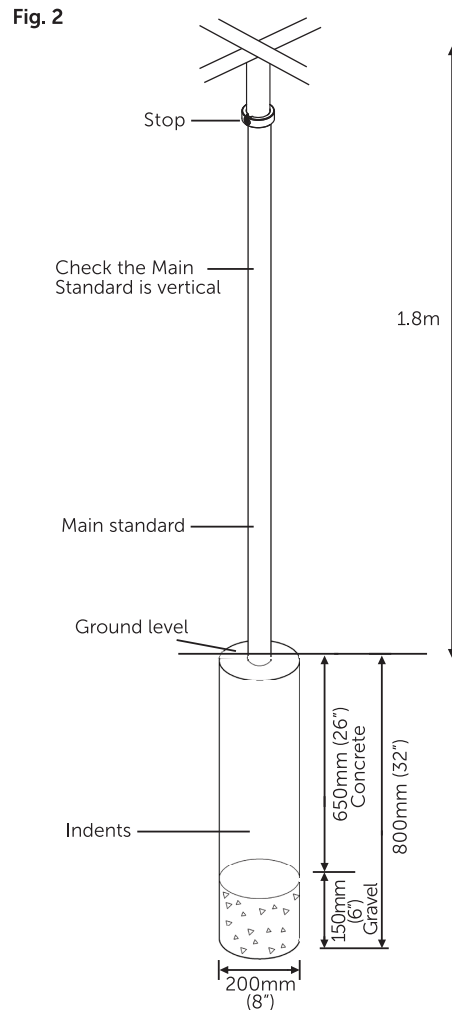
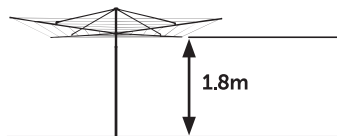

Step 3 – Central Support Assembly

- 3.1 Slide the plug **18** onto the secondary standard. Then slide the stop ring **15** onto the secondary standard (**Fig. 3**).
- 3.1 Using the provided Hex Keys **14** assemble the Stop Ring **15** to the Secondary Standard **2** using the male **16** and female **17** fasteners (**Fig. 4**).
- 3.2 Place the Secondary Standard **2** into the top of the Main Standard **1** and lower it gently (**Fig. 5**).
- 3.3 Tap the plug into the top of the main standard (**Fig. 6**).

Fig. 3

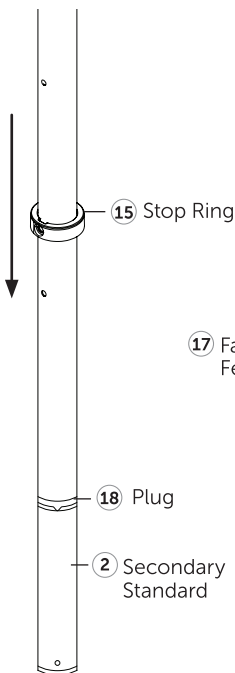

Fig. 4

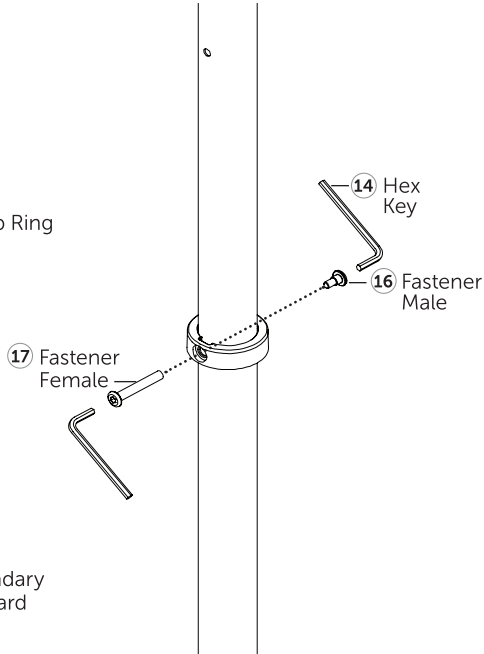

Fig. 5

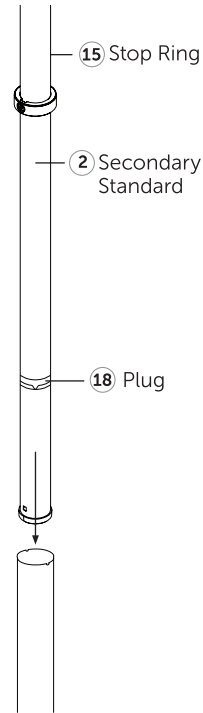
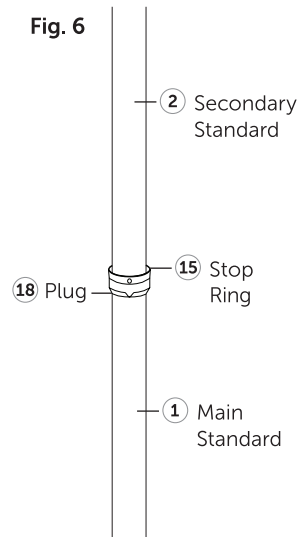

Fig. 6



Step 4 – Arm and Stay Assembly

- 4.1** Locate the arm stay bracket onto the arm. (**Fig. 6**)

Locate the bracket with the 4th hole from the end of the arm (**Fig. 7**).

- 4.2** Squeeze bracket together and fasten securely with bolts **9** and nuts **12**.

- 4.3** Fit tube stays **4** to arm stay brackets and fasten securely with screws **10** and nuts **13**.

Ensure slotted hole at other end is orientated correctly.

- 4.4** Insert the arms **3** into the cross and hook the tube stays **4** to the top of the main standard.

- 4.5** Fit top cap **6** to the top of main standard and fasten securely with screw **11** and nut **13**.

- 4.6** Fit end caps **8** to the end of each arm.

Fig. 6

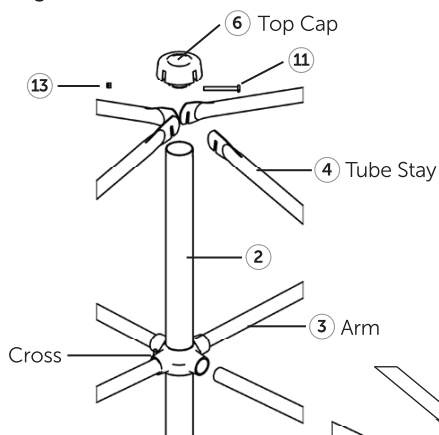
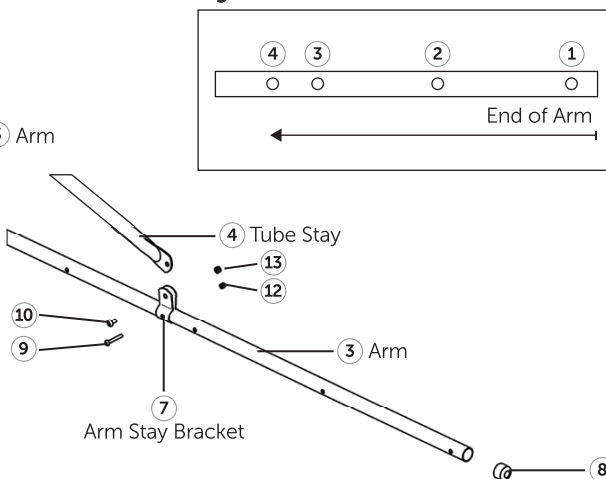

Fig. 7



Step 5 – Wire Assembly

Note: each circuit is wired separately.
Wire cutters & pliers are required

5.1 Unroll the coil of wire.

Start with the innermost circuit
Thread the wire through each hole.

Tie off the wire at the starting point.

Take up any 'slack' and at each hole kink the wire with your thumb to keep the line tight, making sure the arms are not pulled out of line with the opposite arm.

Cut the wire off at approximately 125mm (5") to allow enough to tie off onto the arm.

5.2 Repeat step 1 for all other holes working outward from the centre.

Note: Tie off all wires on one arm. Keep arms square to each other when tensioning lines.

Always wear protective safety glasses when 'wiring-up' your clothesline.

Hills Handy Hints

Commence hanging the washing on the inside line starting with the smallest garments and work your way outwards.

Note: Tie off all wires on one arm. Keep arms square to each other when tensioning lines.

Always wear protective safety glasses when 'wiring-up' your clothesline.

Care and Maintenance

It is a good idea to occasionally inspect all components and check for wear and tear or damage. If there is any damage, parts should be replaced with original Hills spares or the Clothesline repaired before using again.

The Clothesline should be periodically wiped clean with a damp cloth and mild detergent.

Fig. 8

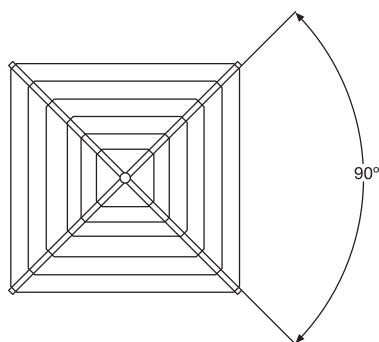
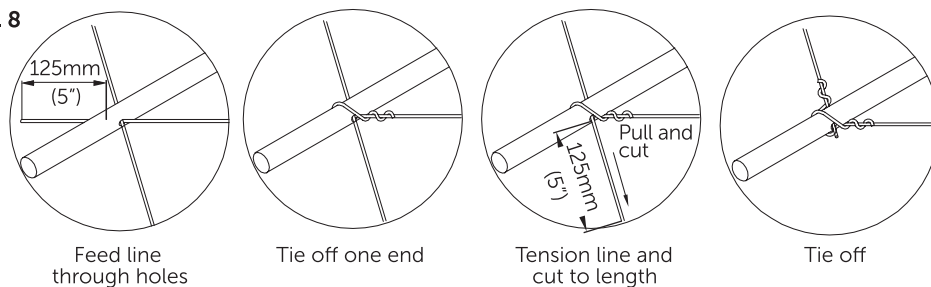

IMPORTANT:

Keep arms square to each other when tensioning the lines.

10-Year Warranty*

*In addition to other rights and remedies that may be available under any applicable law, Cyclone Tools Pty Ltd warrants to the purchaser of the product (customer) that this Clothesline will be free from defects in workmanship and materials for 10 years and the Galvanised Wire for 1 year from the date of purchase of the product. If a defect in material or workmanship becomes evident during that period, Cyclone Tools Pty Ltd will, at its option, either:

- replace the product; or
- refund to the customer the purchase price paid by the customer for the product.

In the event of such a defect, the product should be returned to the place of purchase of the product by the customer, together with proof of purchase, for replacement or refund. Any handling and transportation (and other expenses incurred in claiming under this warranty) are not covered by this warranty and will be borne by the customer, not Cyclone Tools Pty Ltd.

The obligation of Cyclone Tools Pty Ltd under this warranty is limited to the circumstances set out above and is subject to:

- the product not having been altered, tampered with or otherwise dealt with by any person in a manner other than as intended in respect of the relevant product; and
- the product not having been used or applied in a manner that is contrary to customary usage or application of the relevant product or contrary to any stated instructions or specification of Cyclone Tools Pty Ltd (or its related bodies corporate).

For products purchased in Australia:

Our goods come with guarantees that cannot be excluded under the Australian Consumer Law. You are entitled to a replacement or refund for a major failure and compensation for any other reasonably foreseeable loss or

damage. You are also entitled to have the goods repaired or replaced if the goods fail to be of acceptable quality and the failure does not amount to a major failure.

For products purchased in New Zealand:

Our goods come with guarantees that cannot be excluded under the Consumer Guarantees Act. Cyclone Tools Pty Ltd will comply with our obligations to you under the Consumer Guarantees Act.

Cyclone Tools Pty Ltd
ABN 89 169 427 061
Level 1, 660 Doncaster Road,
Doncaster Vic 3108
Phone: 1300 300 564
Email: hhl.enquiries@amesau.com

Hills Contacts

We are committed to providing you with complete customer satisfaction. If you have any questions or comments about our products or services please contact your nearest Customer Service Centre during their local business hours:

Australia
1300 300 564
New Zealand
0800 021 027

Email
hhl.enquiries@amesau.com

Hills Websites
hillshome.com.au
Hills Home Living
hillshome.com.au/need-help/
Hills Consumer Advice

