

WARRANTY

2-Year Warranty*

*In addition to other rights and remedies that may be available under any applicable law, AMES Australasia Pty Ltd warrants to the purchaser of the product (customer) that this product will be free from defects in workmanship and materials for 2 years from the date of purchase of the product. If a defect in material or workmanship becomes evident during that period, AMES Australasia Pty Ltd will, at its option, either:

- replace the product; or
- refund to the customer the purchase price paid by the customer for the product.

In the event of such a defect, the product should be returned to the place of purchase of the product by the customer, together with proof of purchase, for replacement or refund. Any handling and transportation (and other expenses incurred in claiming under this warranty) are not covered by this warranty and will be borne by the customer, not AMES Australasia Pty Ltd.

The obligation of AMES Australasia Pty Ltd under this warranty is limited to the circumstances set out above and is subject to:

- the product not having been altered, tampered with or otherwise dealt with by any person in a manner other than as intended in respect of the relevant product; and
- the product not having been used or applied in a manner that is contrary to customary usage or application of the relevant product or contrary to any stated instructions or specification of AMES Australasia Pty Ltd (or its related bodies corporate).

For products purchased in Australia: Our goods come with guarantees that cannot be excluded under the Australian Consumer Law. You are entitled to a replacement or refund for a major failure and compensation for any other reasonably foreseeable loss or damage. You are also entitled to have the goods repaired or replaced if the goods fail to be of acceptable quality and the failure does not amount to a major failure. For products purchased in New Zealand: Our goods come with guarantees that cannot be excluded under the Consumer Guarantees Act. AMES Australasia Pty Ltd will comply with our obligations to you under the Consumer Guarantees Act.

Hills Contacts

We are committed to providing you with complete customer satisfaction. If you have any questions or comments about our products or services please contact your nearest Customer Service Centre during their local business hours:

Australia

1300 327 293

New Zealand

0800 021 027

AMES Australasia Pty Ltd

ABN 89 169 427 061

Level 1, 660 Doncaster Road,
Doncaster Vic 3108

Email: hills@amesau.com

Website: hillshome.com.au

Consumer Advice: hillshome.com.au/need-help



6 Litre Rechargeable Battery Sprayer



WARNING! READ and UNDERSTAND before using.
Save these instructions for future reference.

WARNING!

- This sprayer is designed and manufactured solely for the purpose of applying consumer grade, water based chemicals. Under no circumstances may it be used for any other purposes.
- The use of heavy duty industrial strength chemicals will damage the sprayer.
- Refer to the chemical manufacturer's label for correct use and safe handling instructions of chemicals before filling or using the sprayer. If unsure of chemical and seal compatibility please contact the chemical manufacturer for further information.
- Prior to using the sprayer all operators must read and fully understand the contents of this instruction manual and all safety information.
- Always wear the recommended safety clothing and equipment when handling chemicals and operating the sprayer.
- Dispose of empty chemical containers and chemical residues in accordance with the instructions supplied by the chemical manufacturer.
- Dispose of the sprayer and lithium ion battery according to your local waste management guidelines – do not simply throw it in the rubbish bin.

DO

- Thoroughly clean after use
- Wear safety goggles and gloves
- Wear protective clothing and mask
- Spray water soluble chemicals
- Ensure adequate ventilation
- Wash hands and face after use
- Store away from sunlight
- Hand tighten fittings only
- Rinse inside of bottle before use
- Read and understand chemical manufacturers' safety directions

DONT

- Spray flammable liquids or solvents
- Eat, drink or smoke when spraying
- Direct spray on humans or animals
- Spray in windy conditions
- Spray in confined spaces
- Leave within reach of children
- Overfill the bottle
- Stand sprayer near naked flame or hot surfaces
- Tighten fittings with pliers etc.
- Allow children to use or person's who have not read the instruction manual
- Modify bottle
- Leave bottle unattended, especially if containing chemicals

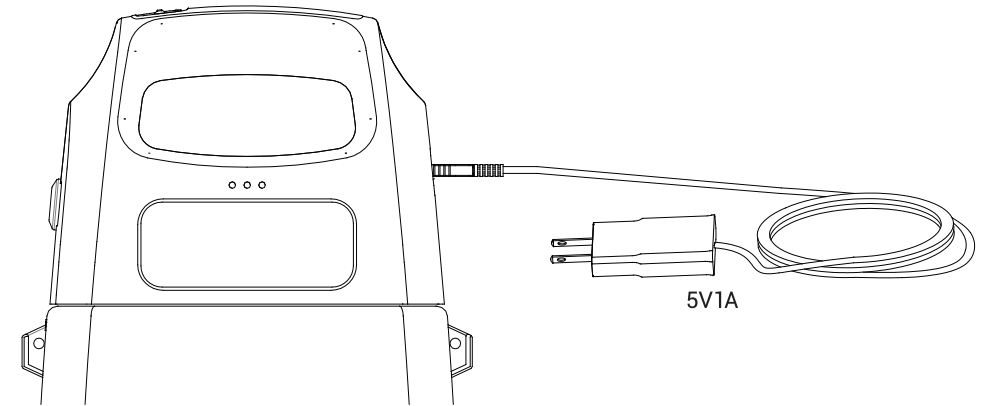

4. The battery is charging when the lights are on. Charging will take around 240 minutes and a full charge will be indicated when all three lights are showing.

- ① Charging light indicator 0-30%
- ② Charging light indicator 30-70%
- ③ Charging light indicator 70-100%

PRODUCT INFORMATION / TECHNICAL DATA

Total Capacity	Voltage	Current Flow	Battery Capacity	Work Time	Charging Time	Flow
6L	5V	0.8A	2.5 Ah	120min	240min	0.3L/min

TROUBLESHOOTING

SYMPTOM

- Pump is working but spray isn't being released
- Battery charger is not charging

REMEDY

- The hose and/or filter may have become blocked. Follow the maintenance advice to remove any blockages and built up residue.
- Check all terminals are fitted correctly and the power socket is working.

MAINTENANCE ADVICE

IMPORTANT

After you have ensured the sprayer contains no pressure, empty any liquid left inside the tank. Dispose of empty chemical containers and chemical residues in accordance with the instructions supplied by the chemical manufacturer.

Note: Even though the bottle may have no liquid left inside, the actual pump chamber may still contain residual fluid in it.

To empty the residual fluid, press the on/off button to ensure that all liquid and air is fully expelled. Refill the bottle with approximately 2 litres of clean tap water, then press the on/off button and start expelling all the water until empty. Do not store in direct sunlight and store out of reach of children.

- Over a period of time chemicals can leave a build up of residue which normal cleaning will not remove. This build up can collect around the seals and inside the hose and pump. If left, this build up will eventually prevent the sprayer from working.
- To overcome this problem we recommend that the sprayer bottle be half filled with hot (not boiling) water from your domestic hot water supply. By pressing the sprayer on/off button and start expelling all the water until empty.
- The hot water should dissolve the built up residue and the sprayer will continue to operate normally.
- Important: For safety, ensure you wear protective clothing, goggles and gloves during this operation.
- Important: If for some reason your sprayer needs to be returned for warranty purposes, PLEASE wash it out thoroughly to protect our service technicians from exposure to unknown substances.

HOW TO USE CHARGER

WARNING! When using the battery charger ensure it is a dry environment and do not leave the charger where it may get wet.

WARNING! Do not leave children unsupervised around the sprayer or charger.

WARNING! The battery charger is only intended to be used with this product.

WARNING! The supply cord cannot be replaced. If the cord is damaged the battery charger should be scrapped.



1. Remove the covering of the micro USB port.

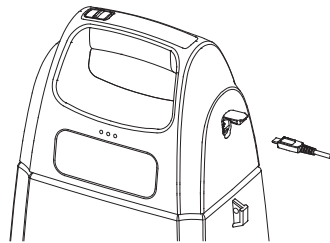

2. Plug in the charger to the port.

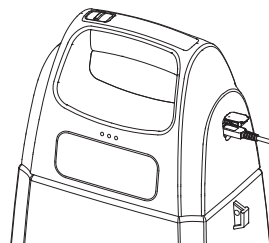

3. Insert the charger into the power.

5

PARTS

- | | |
|--|----------------------------------|
| 1. Tank | 15. Cover R |
| 2. Filter | 16. Handle plate |
| 3. Suck pipe | 17. Water proof cover for on-off |
| 4. Gasket | 18. Strap |
| 5. TPE plug | 19. Lance |
| 6. Cover L | 20. Lance holder |
| 7. Circuit board | 21. Handle hut |
| 8. Screw cover | 22. Handle |
| 9. O Ring | 23. Single ear hose hoops |
| 10. Pump | 24. Handle cover |
| 11. Water proof cover for charging mouth | 25. Hose |
| 12. Plastic hoops | |
| 13. Cover to fix the pump | |
| 14. M3 x 12 screw | |

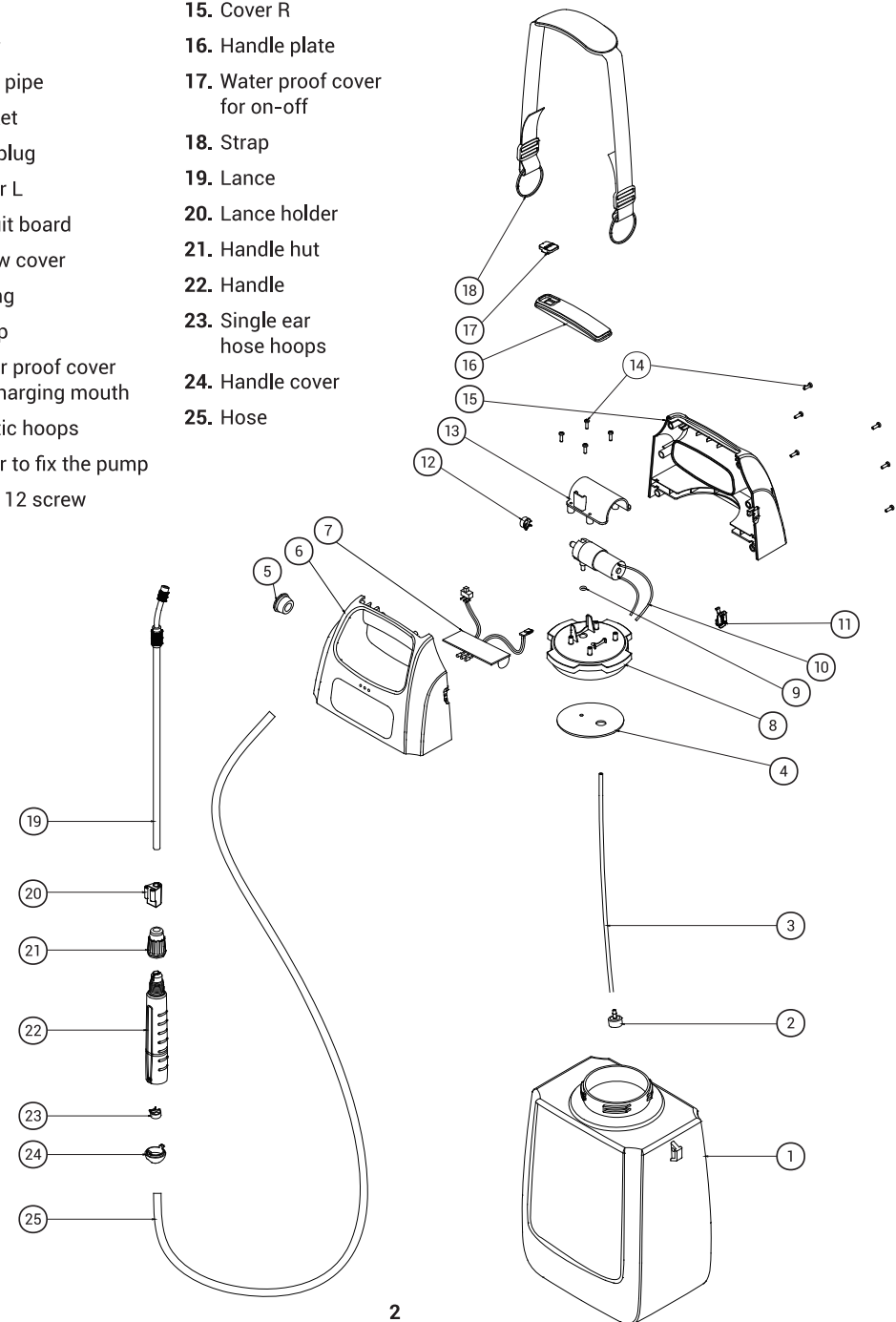

2

OPERATING INSTRUCTIONS

IMPORTANT

- Rinse the inside of the tank with cold water before use.
- Before using any chemicals including herbicides, pesticides, insecticides and weed killers it is advisable to familiarise yourself with the sprayer operation by filling it with water and testing the various spray patterns.
- Thick mixtures can clog the spray nozzle. Solutions of this kind should be strained and diluted to prevent blockages.
- Wash the container, all attachments and your hands thoroughly after each use.
- Always wear the recommended safety clothing and equipment when handling chemicals and operating the sprayer.

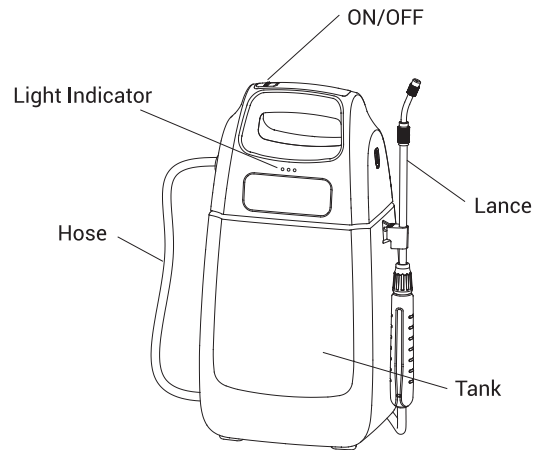

1. Unscrew container lid

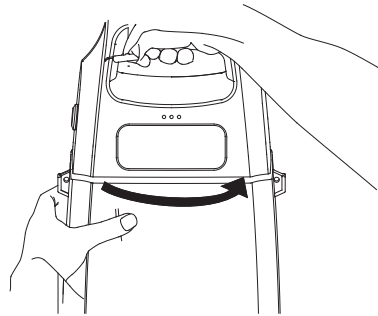

2. Fill the tank and DO NOT exceed the maximum capacity of 6L.

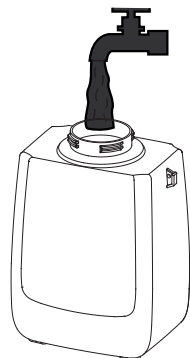

3

OPERATING INSTRUCTIONS

3. Screw container lid back on by hand only.

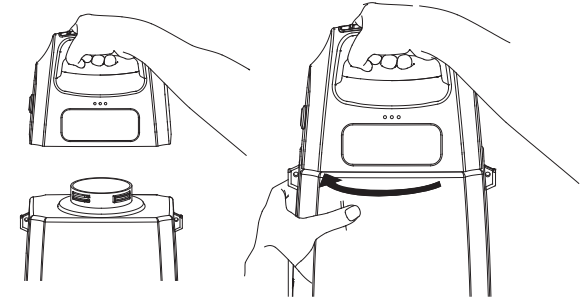

4. Press the on/off button on the tank handle when ready to start spraying.

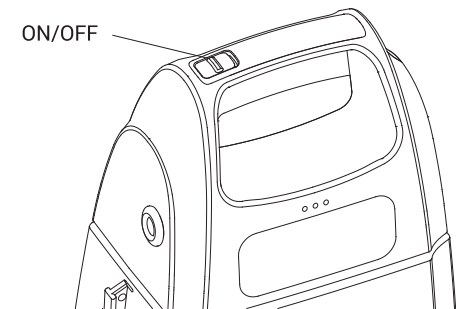

5. Extend the telescopic lance by unscrewing the nut, pulling out the lance to the desired length and securing in place by tightening the nut.

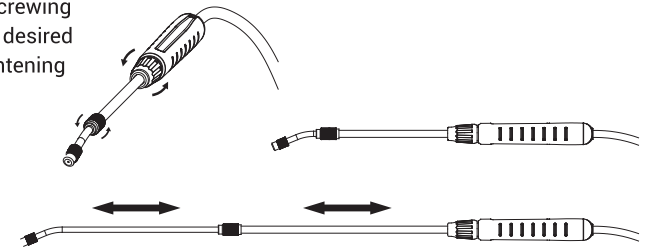

6. Adjust the spray pattern from jet to mist by twisting the brass nozzle.

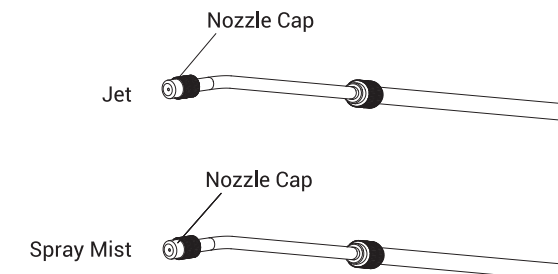

4